

## Silver Series™ 2-Flavour Gourmet Cold Beverage System with Fully Lighted Graphics



### JDF-2S w/Lighted Graphics

(available with iced coffee or juice display)

Dimensions: 33.1"H x 10"W x 25.5"D  
(84.1 cm H x 24.9 cm W x 64.8 cm D)

(Refillable containers sold separately)

## Features

### Gourmet Cold Beverage System

- Fully lighted door graphics bring high visibility to front-of-house applications.
- Superior performance in juice and other concentrated beverage dispensing.
- One dispenser delivers both frozen and ambient products increasing profits by lowering costs.
- Drink consistency assured with the BUNN patented High Intensity<sup>®</sup> mixing technology.
- Pumps and mixes 2+1 to 11+1 concentrated beverages, including 4+1 high viscosity and 5+1 juices accurately and consistently.
- Quick dispense with 1.0 to 1.5 ounces (29.6 to 44.4 ml) per second flow rate.
- 7" (17.8 cm) cup clearance accommodates most juice containers.
- 8 lb. (3.6 kg) ice bank provides superior cold drink capacity.
- Advanced concentrate pump designed for easy setup, accuracy and durability.
- Service-friendly design including modular dispense deck makes service fast and simple.
- Both push-button and portion control in the same machine.
- Available with Iced Coffee or Juice display.
- Preventive maintenance kit: 39690.0000. 

For current specification sheets and other information, go to [www.bunn.com](http://www.bunn.com).

## Related Products

Easy Clear<sup>®</sup> EQHP-10  
Product No. : 39000.0004

Easy Clear<sup>®</sup> EQHP-10CRTG  
Product No. : 39000.1004

Ambient Conversion Kit  
Product No.: 33699.0001  
(one kit required per dispense station - photo shows 4-dispense station unit with one container and three ambient conversion kits)



Refillable Juice Container  
Capacity: 1 Gallon  
Product No.: 39302.0000



## Dimensions & Specifications

Model	Product #	Volts	Amps	Capacity	Shipping Weight	Cord Attached	Agency
JDF-2SA <i>(juice display)</i>	37900.0010	230	4	4 (5 oz.) drinks/min 4 (148 mL) drinks/min	103 lbs. 46.7 kg	Yes	CE NSF
JDF-2SA <i>(iced coffee display)</i>	37900.0011	230	4	4 (5 oz.) drinks/min 4 (148 mL) drinks/min	103 lbs. 46.7 kg	Yes	CE NSF

Capacity: 1 Gallon (3.8 L)

75°F (24°C) incoming water for 180 drinks without exceeding 40°F (4.4°C) finished drink temperature.

Electrical: Model requires 2-wire grounded service rated 220-240V, single phase, 50/60 Hz.

Plumbing: 20-100 psi (138 - 690 kPa). Machine supplied with  $\frac{3}{8}$ " male fitting.

Refrigeration: R-134a refrigerant, 10 oz. (.28 kg), 10 lb. (4.5 kg) ice bank system

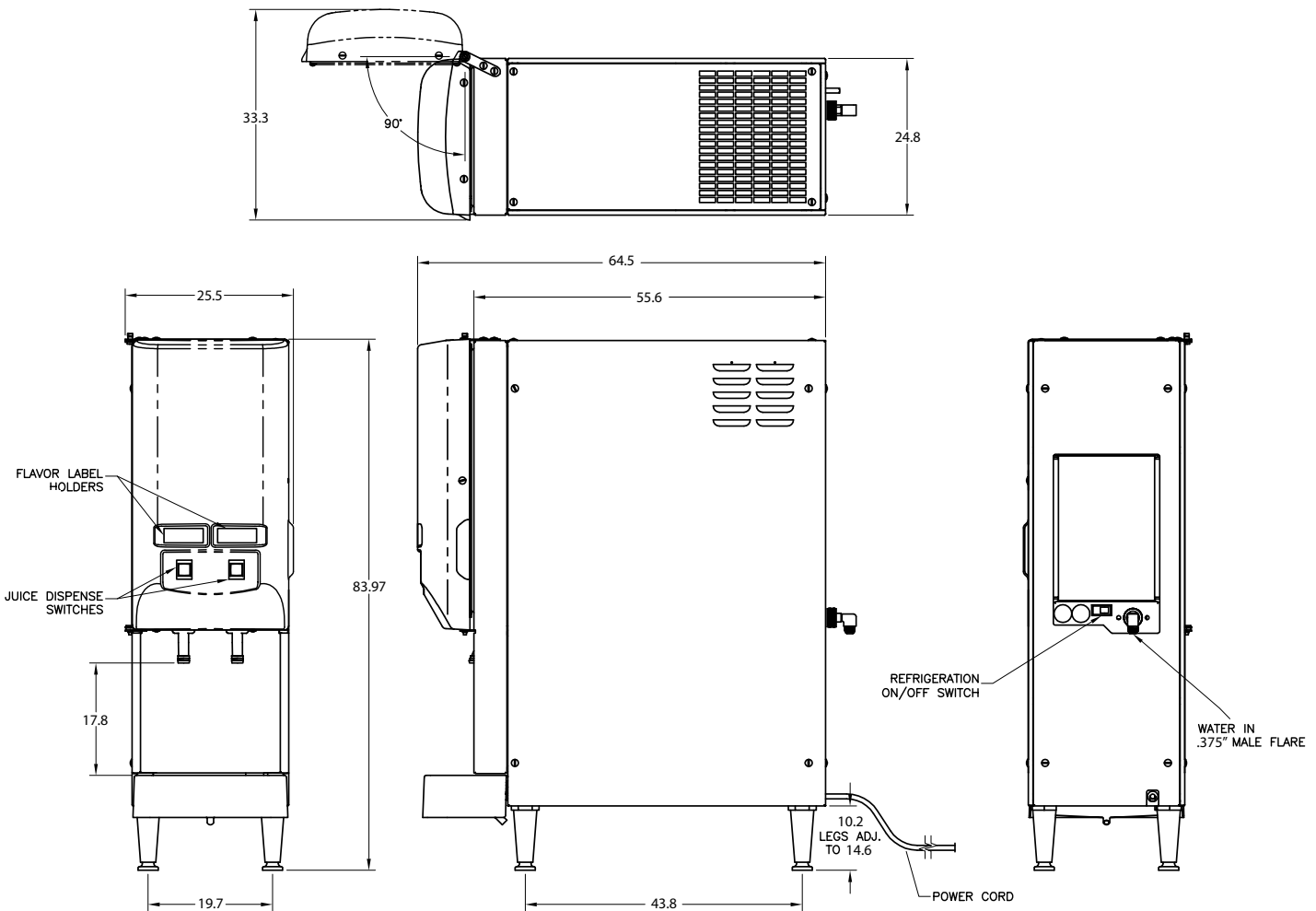

Bunn-O-Matic® Corporation - 1400 Stevenson Drive Springfield, Illinois 62703 • USA • +1-217-529-6601 • Fax +1-217-529-2827 • www.bunn.com

BUNN® practices continuous product research and improvement. We reserve the right to change specifications and product design without notice. Such revisions do not entitle the buyer to corresponding changes, improvements, additions or replacements for previously purchased equipment.

All dimensions shown in centimeters.

3/08 © Bunn-O-Matic Corporation