

ITEM# _____

PROJECT _____

DATE _____

Multi-Hopper Grinder and Storage System



MHG

(includes 2 hoppers)

Dimensions: 29.1"H x 9.36"W x 17.5"D
(73.9cm Hx 23.8cm W x 44.5cm D)

Features

Multi-Hopper Grinder and Storage System

- Convenient, front-loading hoppers allow grinding of a wide variety of coffees.
- Hoppers hold up to 6 lbs. (2.72 kg) each of regular, decaf or specialty beans.
- Stores individual coffee grind weight profiles with 3 batch sizes per hopper.
- Portion controlled for the right amount of coffee every time.
- Precision burrs for consistent, commercial quality grind.
- Hoppers serve as storage containers. Locking lid prevents tampering. (Lock sold separately).
- Easy-to-clean removable hoppers.
- LCD alphanumeric display shows coffee names and diagnostics.
- Display racks promote fresh ground coffee program. (sold separately)
- Accommodates Dual size brew funnel.

BrewWISE® intelligence means the Smart Hopper® manages the grinding and brewing process from start to finish.

- Smart Hopper tells the grinder what coffee is in it through a microchip in the hopper.
- Grinder adjusts the grind time for each batch to deliver the right grind volumes.
- Grinder communicates coffee name to the Smart Funnel during grinding process.
- BrewWISE brewer reads the information in the Smart Funnel, adjusts the recipe, and brews a perfect batch of coffee.
- Create coffee recipe cards with BrewWise recipe writer on your PC.

For current specification sheets and other information, go to www.bunn.com.

International models may vary in appearance.

Related Products

Storage System

2 position rack

Product No.: 36760.0000



4 position rack

Product No.: 36760.0001



Hopper Partition Assembly

Product No.: 36053.0000

Allows for smaller batches of coffee so beans stay fresh

Hopper/Lid Assembly

Product No.: 36845.0000

Dimensions:



Hopper Safety Lock

Product No.: 29734.1000



BrewWISE® Recipe Writer (BRW)

Product No.: 34444.0001



Recipe Card

Product No.: 34447.0000

- Program a recipe to be used on brewer or grinder.



Ad Card

Product No.: 34448.0000

- Program a message to appear on the brewer's display.



Dimensions & Specifications

Model	Product #	Volts	Amps	Décor	Capacity	Shipping Weight	Cord Attached	Agency
MHG-A	35600.0001	230	4.5	SST	2.72 kg per hopper (6 lbs. per hopper)	31.8 kg (70 lbs.)	Yes	CE
MHG-A	35600.0003	230	4.5	Black	2.72 kg per hopper (6 lbs. per hopper)	31.8 kg (70 lbs.)	Yes	CE
MHG-B*	35600.0005	100	9	SST	2.72 kg per hopper (6 lbs. per hopper)	31.8 kg (70 lbs.)	Yes	
MHG-B**	35600.0008	100	9	SST	2.72 kg per hopper (6 lbs. per hopper)	31.8 kg (70 lbs.)	Yes	

Accepts large brew funnels for Single, Dual, and other large BUNN brewers. (sold separately)

Electrical: 230 volt models require 2-wires plus ground service rated 220-240V, single phase, 50/60Hz.

*100 volt model requires 2-wire plus ground service, single phase, 50 Hz.

**100 volt model requires 2-wire plus ground service, single phase, 60 Hz.

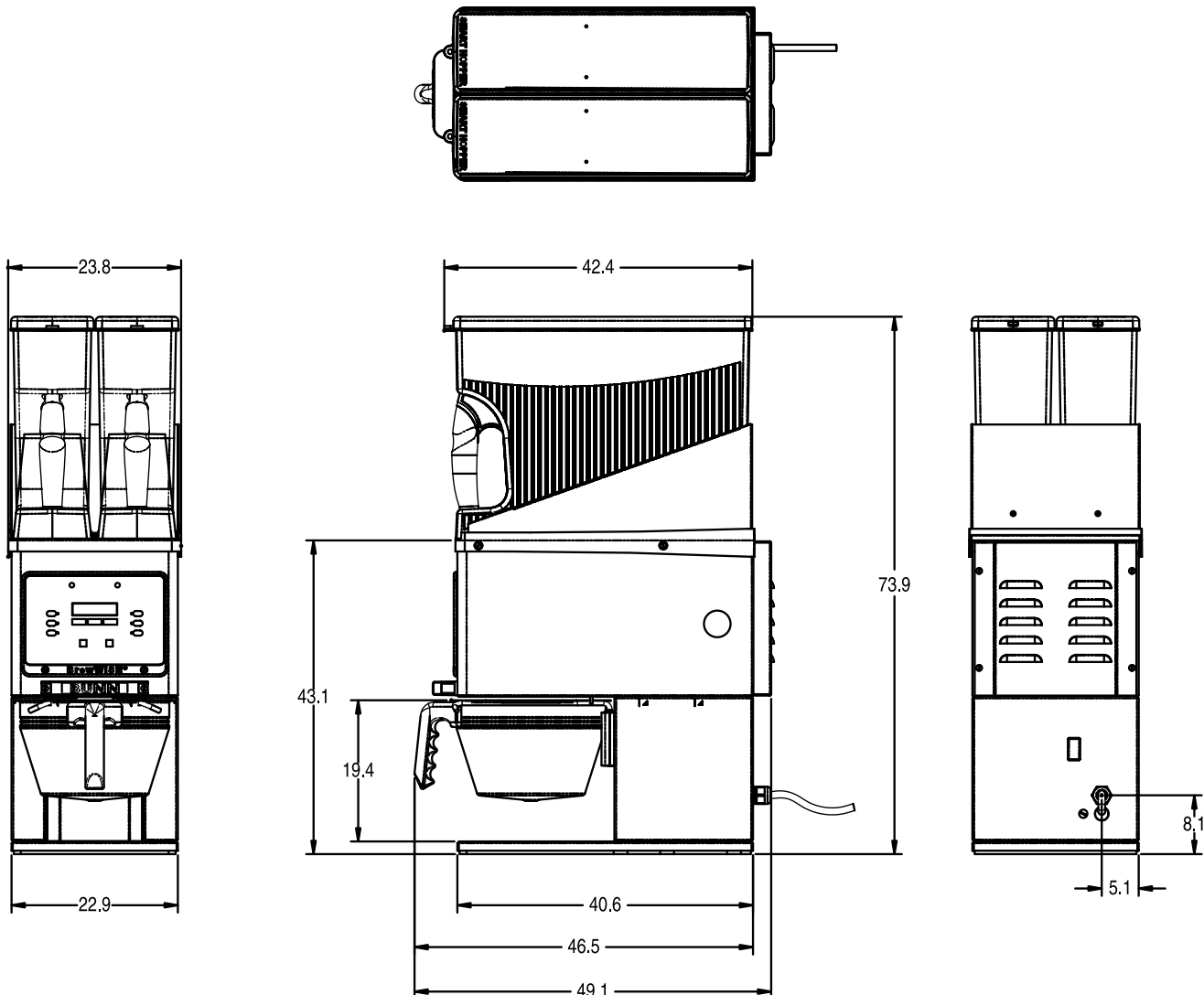

Bunn-O-Matic® Corporation - 1400 Stevenson Drive Springfield, Illinois 62703 • USA • +1-217-529-6601 • Fax +1-217-529-2827 • www.bunn.com

BUNN® practices continuous product research and improvement. We reserve the right to change specifications and product design without notice. Such revisions do not entitle the buyer to corresponding changes, improvements, additions or replacements for previously purchased equipment.

All dimensions shown in centimeters. Bunn-O-Matic Corporation owns all copyrights relating to materials in this publication. Please contact BUNN to request permission to reproduce any portion of this publication.